

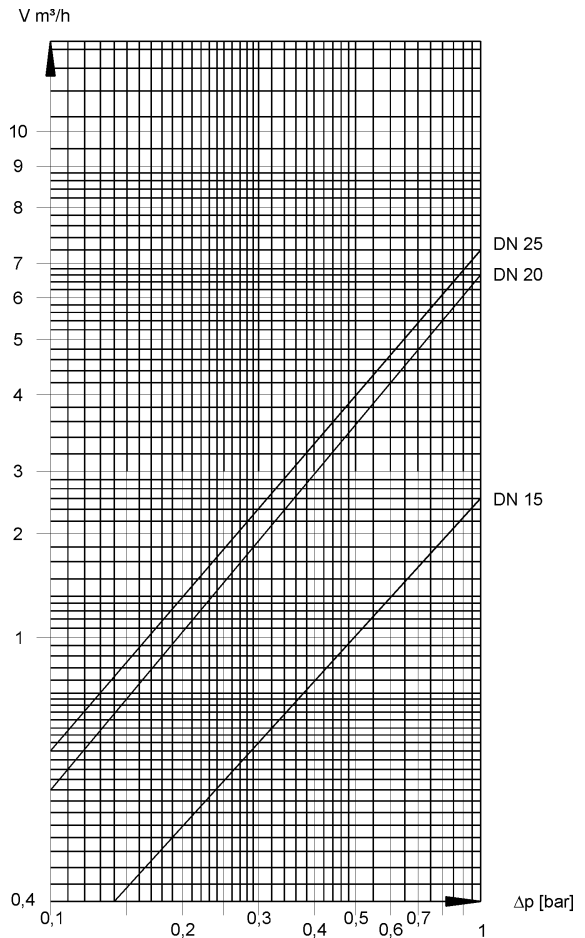

# Pressure regulating valve

## Type 6203

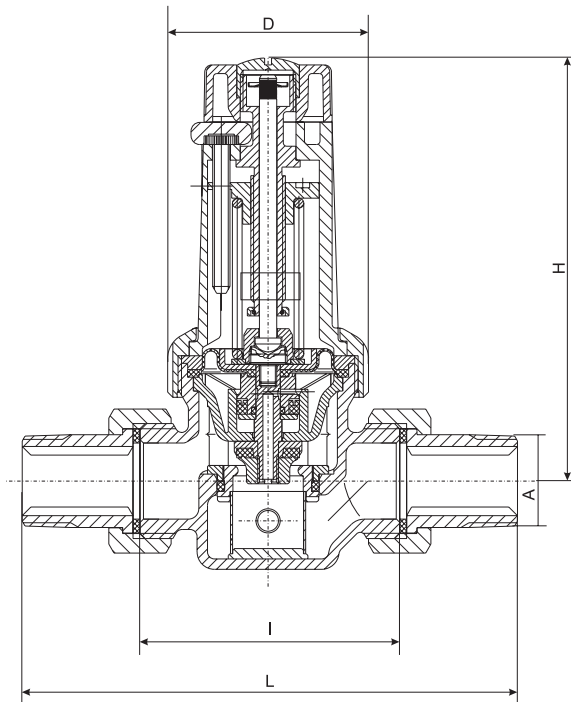

Type	Adjustment range [bar]	DN	A [mm]	H [mm]	L [mm]	I [mm]	D [mm]
6203.1 6203.2	1-5 4-8	15	1/2	123	132	75	58
6203.1 6203.2	1-5 4-8	20	3/4	123	143	75	58
6203.1 6203.2	1-5 4-8	25	1	121	161	87	58

### Field of application:

The pressure regulating valve type 6203 is designed to regulate the pressure in installations and devices for industrial applications with media as given in the specifications mentioned below. It opens as a proportional regulating valve with increasing pressure and as a result prevents any excessive pressure increase in the preceding installation. The design of the pressure regulating valve also allows the use with drain pipes of a longer size where backpressures can occur.

### Installation:

The pressure regulating valve is installed in an appropriate place in the pipework in a stress-relieved way under consideration of the flow direction. The mounting position is left to personal choice. The pipes have to be thoroughly cleaned prior to the installation of the valve.

### Operation:

The desired pressure is adjusted by means of the adjusting knob. The valve can be adjusted to the opening pressure or to a desired system pressure occurring at maximum flow rate. Under normal operating conditions the valve needs no maintenance. Only the well running of the valve system has to be checked at regular intervals; any dirt amassed in the strainer has to be removed simultaneously. In case of wear of the sealing elements or of the diaphragm, the complete cartridge can be taken out of the valve body and replaced with a new one.

### Design:

Pressure regulating valve operating as a proportional, diaphragm controlled valve; complete control part exchangeable as a cartridge from the screw cap side. Body made of bronze, screw cap made of glass-fibre reinforced plastics, inner parts made of dezincification resistant material, sealing elements made of heat and ageing resistant elastomeric material, diaphragm reinforced with polyamide material, piston guidance made of synthetics resisting to very high temperatures, spring made of spring steel wire, protected against corrosion.

- Working overpressure: max. 25 bar
- Opening overpressure: adjustable 1 bar to 5 bar or 4 bar to 8 bar
- Working temperature: max. 110°C
- Flow rate: see diagramme
- Media: water, neutral liquids, oil-free air, neutral gases

\*Other connection sizes up to DN 50 on request.

## Pressure regulating cartridge

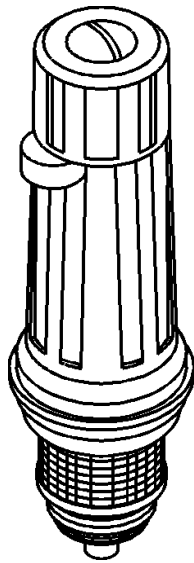

<b>Size</b>	<b>Article-No.</b>
DN 20	6203.20.900
DN 25	6203.25.901
DN 32	6203.32.900